

REFRIGERATOR MANUFACTURER
Turbo air
 more durable, efficient, beautiful

4184 E. Conant St.
 Long Beach, CA 90808
 Tel. 310-900-1000
 Fax. 310-900-1077
www.turboairinc.com

Project :	
Model # :	
Item # :	Qty :
Available W/H :	
Approval :	

Glass Door Merchandiser

Glass Door Merchandisers
 Super Deluxe Series

Model : TGM-5SD

FEATURES / BENEFITS

LED LIGHTING INTERIOR DISPLAY SYSTEM

Brighter and longer lasting LED lights provide attractive, enhanced illumination compared to fluorescents. It saves energy by producing less heat, while maximizing the visibility in the display area.

MODERN DESIGN

By harmonizing curvature and rigidity, our modern style product designs are user-friendly while maintaining the highest product visibility and aesthetics.

TRIPLE PANE AIR INSULATED LAYER GLASS DOORS

Equipped with unique triple pane glass doors with a layer of patented, transparent thermal insulating film applied between the glass layers. Lightweight door construction reduces door maintenance and roller/bushing wear, and facilitates smooth door opening.

EFFICIENT REFRIGERATION SYSTEM

Turbo Air's glass door merchandisers are designed with oversized and balanced (CFC Free R-134A) refrigeration systems. These include efficient evaporators and condensers for faster cooling and greater efficiency.

HIGH-DENSITY POLYURETHANE INSULATION

The entire cabinet structure is foamed-in-place using high density, CFC free polyurethane insulation.

ERGONOMICALLY DESIGNED DOORS

Customers' fatigue fades away with easy grip handles and doors that open effortlessly. These features along with self-closing doors make this the ultimate choice in customer convenience.

BOTTOM MOUNT COMPRESSOR UNITS

Turbo Air's bottom mount compressor allows easier access for service and extra storage space above. In addition, the lower area provides a cooler and less greasy operating environment which results in reduced compressor running time.

MAGNETIC DOOR GASKETS

Magnetic door gaskets are of one piece construction, removable without tools for ease of cleaning and replacement.

ADJUSTABLE, HEAVY DUTY, PE (POLYETHYLENE) COATED WIRE SHELVES

3 YEAR PARTS & LABOR WARRANTY



TGM-5SDB



TGM-5SDV



TGM-5SDW

REFRIGERATOR HOLDS 33°F ~ 38°F FOR THE BEST IN BEVERAGE PRESERVATION



ENERGY STAR®
 Qualified

Model	Swing Door	CU./FT.	#of Shelves	HP	AMPS	Crated Weight (lbs.)	L x D* x H† (inches)
TGM-5SD	1	5.9	2	1/7	3.0	183	25 x 23 1/4 x 30 1/2

Model : TGM-5SD

ELECTRICAL DATA	
Voltage	115/60/1
Plug Type	 NEMA-5-15P
Full Load Amperes	3.0
Compressor HP	1/7
Cord Length ft.	9
Refrigerant	R-134A
DIMENSIONAL DATA	
# of Doors	1
Net Capacity cu. ft.	5.9
Ext. Length Overall in.	25 (635mm)
Ext. Depth Overall in.*	23 1/4 (590mm)
Ext. Height Overall in.†	30 1/2 (775mm)
Int. Length Overall in.	20 5/8 (525mm)
Int. Depth Overall in.	18 3/4 (475mm)
Int. Height Overall in.	26 1/4 (665mm)
Gross Weight lbs.	183
Net Weight lbs.	152
# of Shelves	2
Shelf Size (LxD) in.	19 3/8 x 16 5/8

Design and specifications subject to change without notice.

Actual shipping weight may differ due to extra packing materials for product protection.

* Depth does not include 2-1/4" for door handle.

† Depth does not include 2-3/8" for rear mechanical component and additional 1-5/8" for a power cord bushing & radius of curvature.

‡ Height does not include 2-1/4" (56mm) for leg height.

- **WARRANTY : 3 Year Parts and Labor Warranty**
Additional 2 Year Warranty on Compressor
- **THREE COLOR OPTIONS AVAILABLE (STANDARD)**
Super Deluxe series comes in white cabinet (W), white cabinet with wine color trim (V) or black cabinet with black color trim (B).
- **DOOR LOCKING SYSTEM STANDARD**
- **OPTIONAL 4" CASTERS AVAILABLE (EXCEPT TGM-5SD, 7SD)**
- 1/2" DIAMETER & 13 TPI (THREADS PER INCH)

PLAN VIEW

(unit : inch)

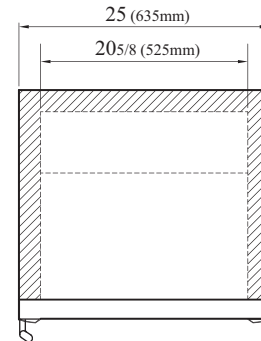

TOP VIEW

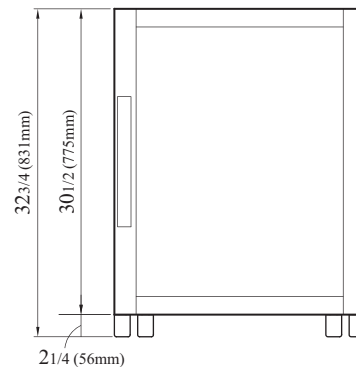

FRONT VIEW

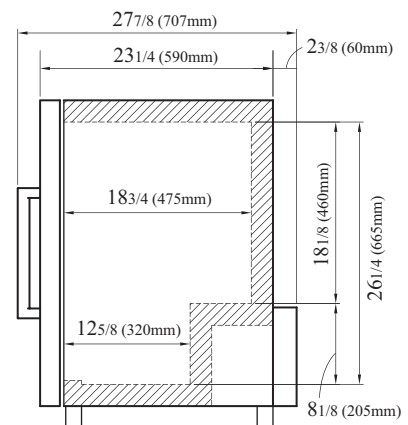

SIDE VIEW

Ver.201401



ENERGY STAR®
Qualified

- Turbo Air : 800-627-0032
- GK : 800-500-3519
- Warranty : 800-381-7770
- AC : 888-900-1002

